

ROLINE 19" Blank Panel, Snap-in, 1U, Metal, black

Product No.	26.30.0000
Manufacturer	ROLINE
Manufacturer No.	26.30.0000
EAN (single piece)	7630049618732

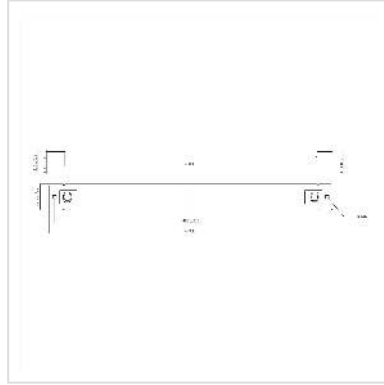

Tool-free

ROLINE 19" blind panel painted in RAL 7035 (light grey) to cover unneeded HE - with snap-in mechanism for quick and easy mounting without cage nuts or other accessories.

- Suitable for all 19" network or server cabinets
- For use in 19" server cabinets to conceal unneeded installation spaces
- Easy to mount or dismount via snap-in mechanism
- Does not require any tools or cage nut mounting screws
- Snap-in functionality
- Material: Steel
- 19" blind with one height unit (1UH)
- RAL 9005 Paint finish, noir

Technical specifications

Manufacturer	ROLINE
Product group	19"-/10"-Additional accessories
Product type	Blind cover
Colour	black
Scope of delivery	Blind plate

RAL colour	RAL 9005 Jet black
Weight	207.7 g
Height of packaging (single piece)	10 mm
Width of packaging (single piece)	50 mm
Depth of packaging (single piece)	490 mm
Package weight (single piece)	0.21 kg